

WESAN WB 234

BULK WATER METER | WOLTMAN

HYDROMETER



APPLICATION

For installation at a transition from a vertical to a horizontal pipe (e.g. in a well).

FEATURES

- ▶ Calibratable and exchangeable measuring insert
- ▶ Outstanding long-term accuracy even under extreme loads
- ▶ Measuring range for small flow rates considerably larger than specified for metrological class
- ▶ Complete head unit with counter and sensors can be rotated by 350° for easier reading
- ▶ Encapsulated counter of glass/copper IP 68
- ▶ Integrated measurement outputs as standard
- ▶ Sensors for remote readout (digital) and flow measurement (analogue) can be retrofitted on site without affecting calibration
- ▶ Up to two different digital outputs and one analogue output simultaneously

WESAN WB 234

BULK WATER METER | WOLTMAN

GENERAL

WESAN WB 234		
Medium temperature range	°C	0 ... 30
Temperature safety	°C	0 ... 50
Ambient operating temperature	°C	0 ... 55
Ambient storage temperature	°C	0 ... 55
Nominal pressure	PN bar	16*
Protection class		IP 68

* See also special versions.

TECHNICAL DATA

Nominal diameter	DN	mm	50	80	100	150	200
Nominal flow rate (DIN ISO 4064)	Q _n	m ³ /h	15	40	60	150	250
Permissible continuous load (HY)	Q _n	m ³ /h	25	55	90	200	300
Maximum flow rate (short-term)	Q _{max}	m ³ /h	50	110	180	350	600
Transition flow rate	Q _t	m ³ /h	1	1.2	1.5	5	20
Minimum flow rate	Q _{min}	m ³ /h	0.2	0.25	0.3	0.8	4
Starting flow rate		l/h	60	90	90	150	370
Flow rate at 0.1 bar pressure loss		m ³ /h	25	50	78	250	295

PULSE OUTPUTS

Nominal diameter	DN	mm	50	80	100	150	200
Reed switch 570* - pulse value 1		l/pulse	100	100	100	1000	1000
Reed switch 570* - pulse value 2		l/pulse	1000	1000	1000	10000	10000
Special pulse value		l/pulse	2.5 / 5 / 10 / 25 / 50	2.5 / 5 / 10 / 25 / 50	2.5 / 5 / 10 / 25 / 50	25 / 50 / 100 / 250 / 500	25 / 50 / 100 / 250 / 500
IR pulse transmitter 573*		l/pulse	1	1	1	10	10

* For more information about reed switch 570 and IR pulse transmitter 573 please have a look at the specific datasheet.

DISPLAY RANGE

Nominal diameter	DN	mm	50	80	100	150	200
0.5 l ... 999,999 m ³			•	•	•		
5.0 l ... 9,999,999 m ³						•	•

APPROVAL

Nominal diameter	DN	mm	50	80	100	150	200
EC			D 95 / 6.132.37	D 95 / 6.132.37	D 95 / 6.132.37	D 86 / 6.132.21	D 86 / 6.132.21
Metrological class			B•H	B•H	B•H	B•H	B•H

WESAN WB 234

BULK WATER METER | WOLTMAN

DIMENSIONS

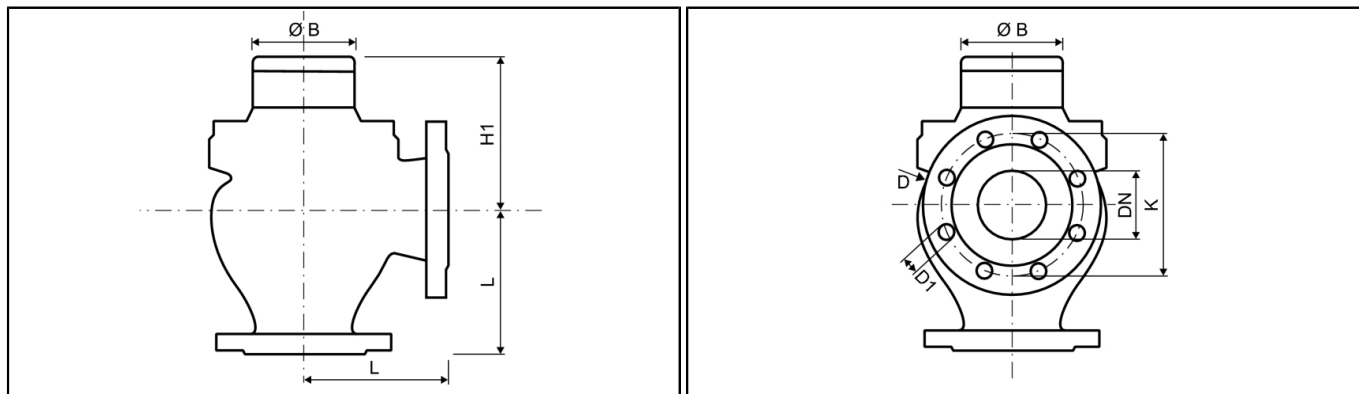

Nominal diameter	DN	mm	50	80	100	150	200
Overall length (DIN 28537)	L	mm	150	180	200	250	300
Overall length (DIN 28637)	L	mm	-	165	180	220	260
Flange diameter	D	mm	165	200	220	300	360
Hole circle diameter	K	mm	125	160	180	240	295
Number of screwholes		pcs	4	8 / 4	8	8	8 / 12
Screw hole diameter	D1	mm	18	18	18	23	23
Height	H1	mm	124	140	149	219	264
Height to remove measuring insert		mm	260	320	330	485	586
Meter width		mm	173	222	222	310	352
Diameter	Ø B	mm	110	110	110	110	110
Weight		kg	14.2	26.6	33.3	71.5	130

SPECIAL VERSIONS

- Versions with different nominal pressure on request
- Special flange holes
- For other media
- For different pulse values
- Electronic counter module

WESAN WB 234

BULK WATER METER | WOLTMAN

PRESSURE LOSS GRAPH / TYPICAL ERROR GRAPH

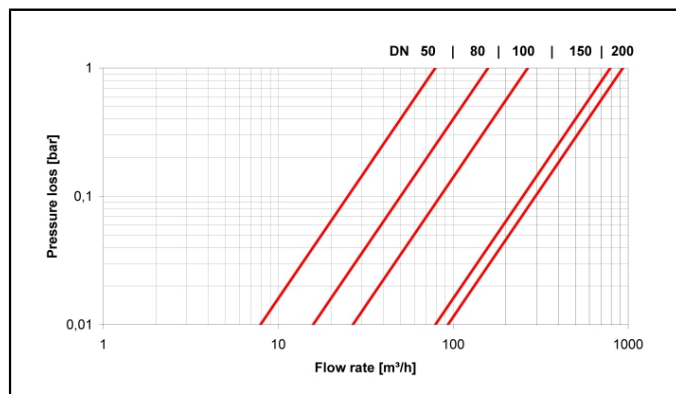

Pressure loss graph

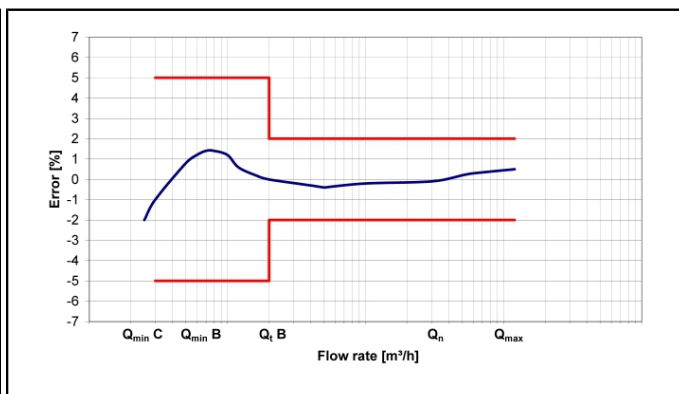

Typical error graph

HYDROMETER

HYDROMETER GmbH · Postfach 1462 · 91505 Ansbach
Tel. +49 981 1806-0 · Fax: +49 981 1806-615 · info@hydrometer.de · www.hydrometer.de
Subject to technical adjustments

 smart in solutions